

Trim elements to roof/shell tool has issues.

Trim Elements to Roof/Shell tool applied to selected wall.

As highlighted below, wall continuing beyond roof boundary is no longer visible in 3D view, but the same wall is still visible as original condition in Plan. This generates incorrect graphics representation, if wall is not visible in plan then should also be visible in 3D view without trim condition for area beyond roof boundary.

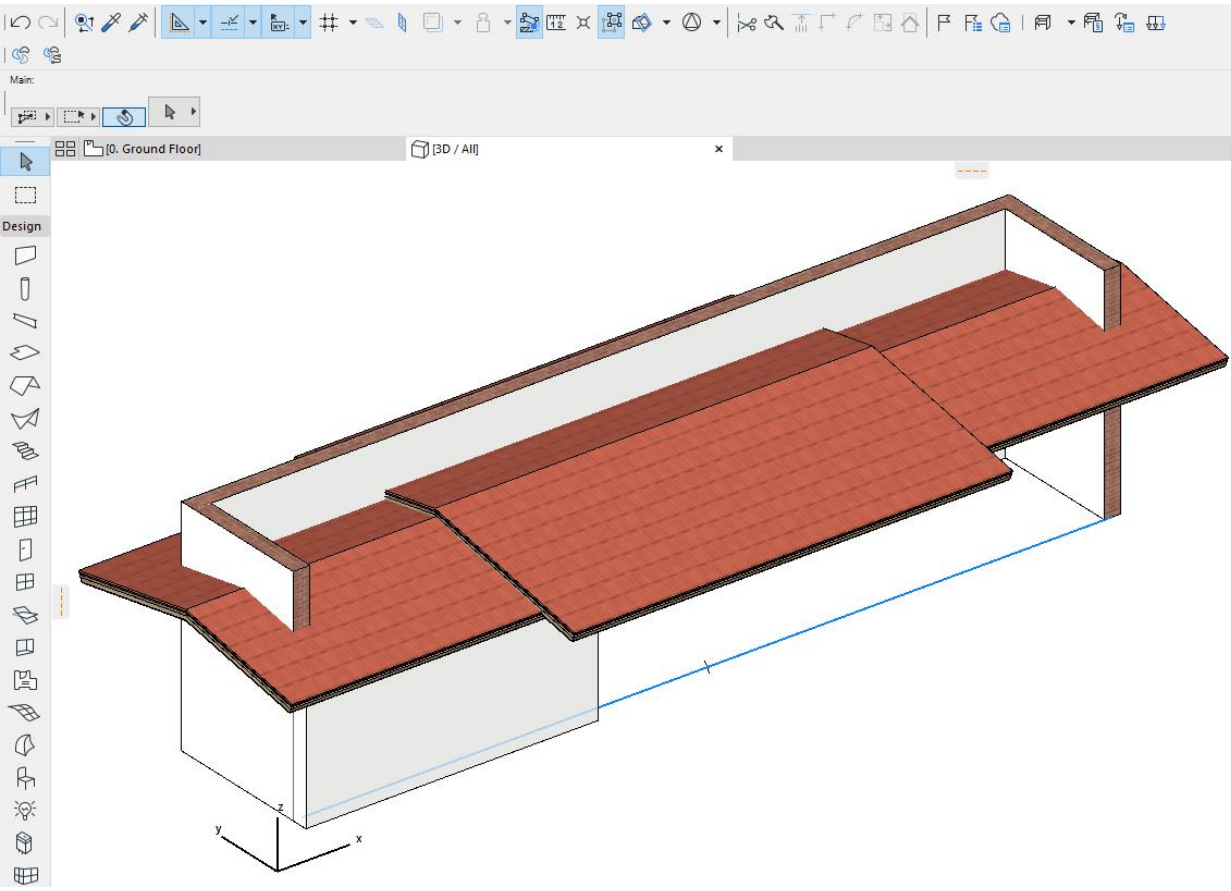

3D View

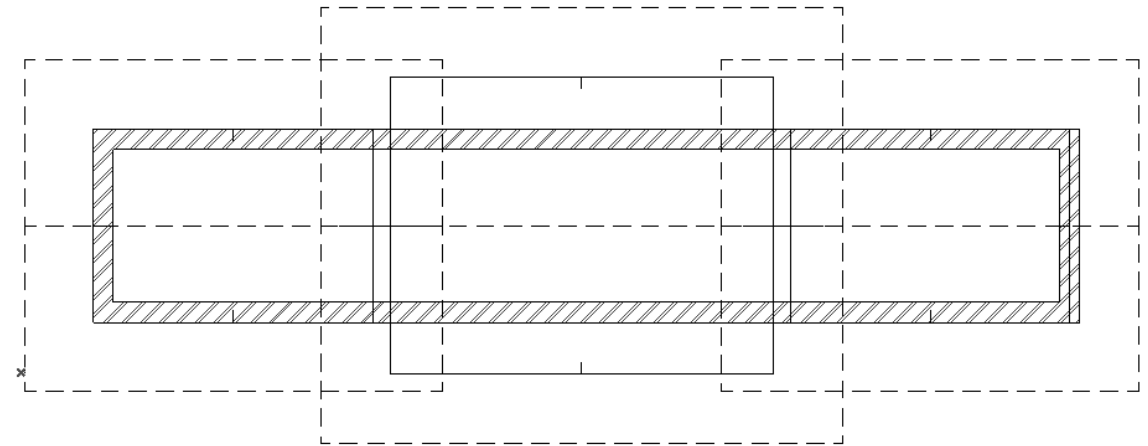

Plan View