

**FLOOR PLAN NOTES**

**STUDS:**  
ALL FRAMING & FIXINGS ARE BASED ON A HIGH WIND ZONE.  
2.425m STUD HEIGHT (2440mm TO U/S OF TRUSSES).  
STUDS TO BE AS PER NZS 3604:2011.

**STUDS - LOADBEARING WALLS:**  
H1.2 SGB 90 x 45 AT 600mm CRS.  
**NON LOADBEARING EXTERNAL WALLS:**  
H1.2 SGB 90 x 45 STUDS AT 600 CRS.  
**NON LOADBEARING INTERNAL WALLS:**  
H1.2 SGB 90 x 45 STUDS AT 600 CRS.  
**NOGS:**  
H1.2 SGB NOGS @ 800 CRS

**WALL CLADDING:**  
- 70 SERIES CONCRETE BRICK VENEER WITH 50mm CAVITY EXTERIOR CLADDING SYSTEM  
- H3.1 HORIZONTAL BEVELBACK TIMBER WEATHERBOARDS ON 20mm CAVITY.  
- ALL CLADDING SYSTEMS ARE TO BE INSTALLED AS PER REQUIREMENTS OF NZBC E3(A)1 & MANUFACTURER'S INSTALLATION INSTRUCTIONS.  
- THERMAKRAFT WATERGATE PLUS BREATHABLE BUILDING WRAP.  
- INTERNAL WALL LINING USING 10mm GIB STANDARD PLASTERBOARD.  
- USE GB A QUALINE TO WET AREAS.  
- INSTALLED AS PER MANUFACTURER'S RECOMMENDATIONS.

**WET AREA NOTES:**  
FLOOR & WALL LININGS IN THE KITCHEN & BATHROOM TO COMPLY WITH NZBC E3(A)1.

**ROOF CLADDING:**  
SELECTED METAL TILE ROOFING OVER SELF SUPPORTING ROOF UNDERLAY INSTALLED AS PER MANUFACTURER'S INSTRUCTIONS & DETAILS & AS PER NZBC E3 REQUIREMENTS.

**ROOF RITCH:** 25° FOR MAIN ROOF & ENTRY.  
- INTERNAL CEILING LINING USING 13mm GB STANDARD PLASTERBOARD & CEILING STEEL BATTEN SYSTEM @ 600 CRS.  
- USE GB A QUALINE TO WET AREAS. INSTALL AS PER MANUFACTURER'S RECOMMENDATIONS.

**JOINERY:**  
SELECTED POWDER COATED ALUMINIUM JOINERY DOUBLE GLAZED. ALL GLAZING & SAFETY GLAZING TO COMPLY WITH REQUIREMENTS OF NZBC F2(A)1.

**SMOKE ALARMS:**  
INSTALL SMOKE ALARMS, AS PER REQUIREMENTS OF NZBC F7(A)1.

DWELLING FLOOR AREA	
FLOOR AREA OVER FRAME	=54.25m <sup>2</sup>
FLOOR AREA OVER CLADDING	=58.0m <sup>2</sup>
ROOF PLAN AREA	=74.18m <sup>2</sup>

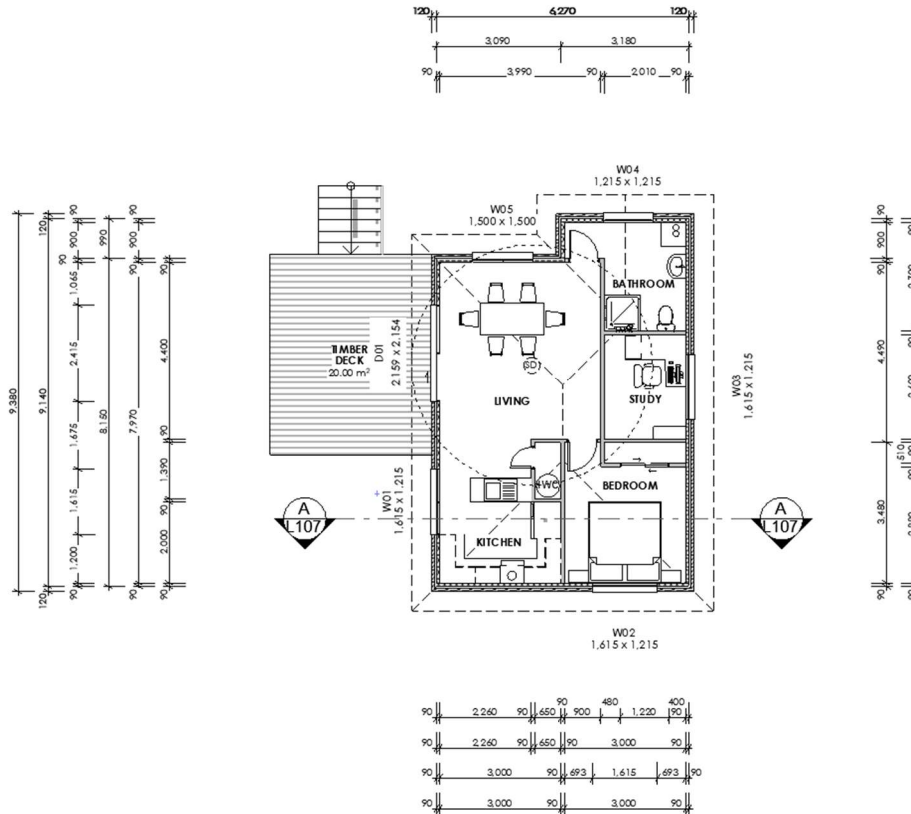

RevID	ChID	Revision	Date
BC-01		BUILDING CONSENT	14/07/2022



AgFox Solutions	SHEET	SHEET TITLE	GROUND	<b>Mr &amp; Mrs Brian Cambell</b> <b>CD 400 Assignment 3B</b> 12 Sea Dune Place Ruakaka,	PO BOX 1234 <b>SCALE 1:100</b> PHONE: 021 2135 501 MOBILE: 022 345 6789 Tms@AgFoxDesign.co.nz WWW.AgFoxDesign.CO.NZ
	REV	FLOOR PLAN			
		REVISION #	BC-01		
		DRAWN BY:	TJS		
		CHECKED BY:	BHANLEY		
	ISSUED:	4/07/2022			
	PROJECT #:	22-001			