

FLOOR PLAN NOTES

STUDS:
ALL FRAMING & FIXINGS ARE BASED ON A HIGH WIND ZONE.

2.425m STUD HEIGHT (2460mm TO U/S OF TRUSSES).
STUDS TO BE AS PER NZS 3604:2011.

STUDS - LOADBEARING WALLS:

H1.2 SG8 90 x 45 AT 600mm CRS.

NON LOADBEARING EXTERNAL WALLS:

H1.2 SG8 90 x 45 STUDS AT 600 CRS.

NON LOADBEARING INTERNAL WALLS:

H1.2 SG8 90 x 45 STUDS AT 600 CRS.

NOGS:

H1.2 SG8 NOGS @ 800 CRS

WALL CLADDING:

- 70 SERIES CONCRETE BRICK VENEER WITH 50mm CAVITY EXTERIOR CLADDING SYSTEM

- H3.1 HORIZONTAL BEVELBACK TIMBER WEATHERBOARDS ON 20mm CAVITY.

- ALL CLADDING SYSTEMS ARE TO BE INSTALLED AS PER REQUIREMENTS OF NZBC E3/AS1 & MANUFACTURER'S INSTALLATION INSTRUCTIONS.

- THERMAKRAFT WATERGATE PLUS BREATHABLE BUILDING WRAP.

- INTERNAL WALL LINING USING 10mm GIB STANDARD PLASTERBOARD.

- USE GIB AQUALINE TO WET AREAS. INSTALLED AS PER MANUFACTURER'S RECOMMENDATIONS.

WET AREA NOTES:

FLOOR & WALL LININGS IN THE KITCHEN & BATHROOM TO COMPLY WITH NZBC E3/AS1.

ROOF CLADDING:

SELECTED METAL TILE ROOFING OVER SELF SUPPORTING ROOF UNDERLAY INSTALLED AS PER MANUFACTURER'S INSTRUCTIONS & DETAILS & AS PER NZBC E2 REQUIREMENTS.

ROOF PITCH: 25° FOR MAIN ROOF & ENTRY.

- INTERNAL CEILING LINING USING 13mm GIB STANDARD PLASTERBOARD & CEILING STEEL BATTEN SYSTEM @ 600 CRS.

- USE GIB AQUALINE TO WET AREAS. INSTALL AS PER MANUFACTURER'S RECOMMENDATIONS.

JOINERY:

SELECTED POWDER COATED ALUMINIUM JOINERY, DOUBLE GLAZED. ALL GLAZING & SAFETY GLAZING TO COMPLY WITH REQUIREMENTS OF NZBC F2/AS1.

SMOKE ALARMS:

INSTALL SMOKE ALARMS, AS PER REQUIREMENTS OF NZBC F7/AS1.

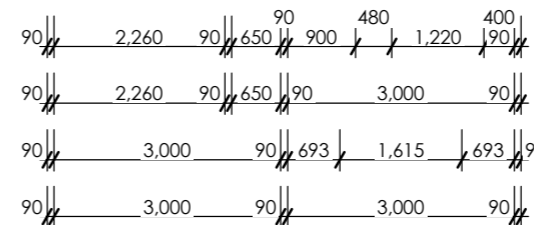
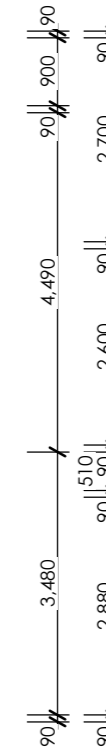
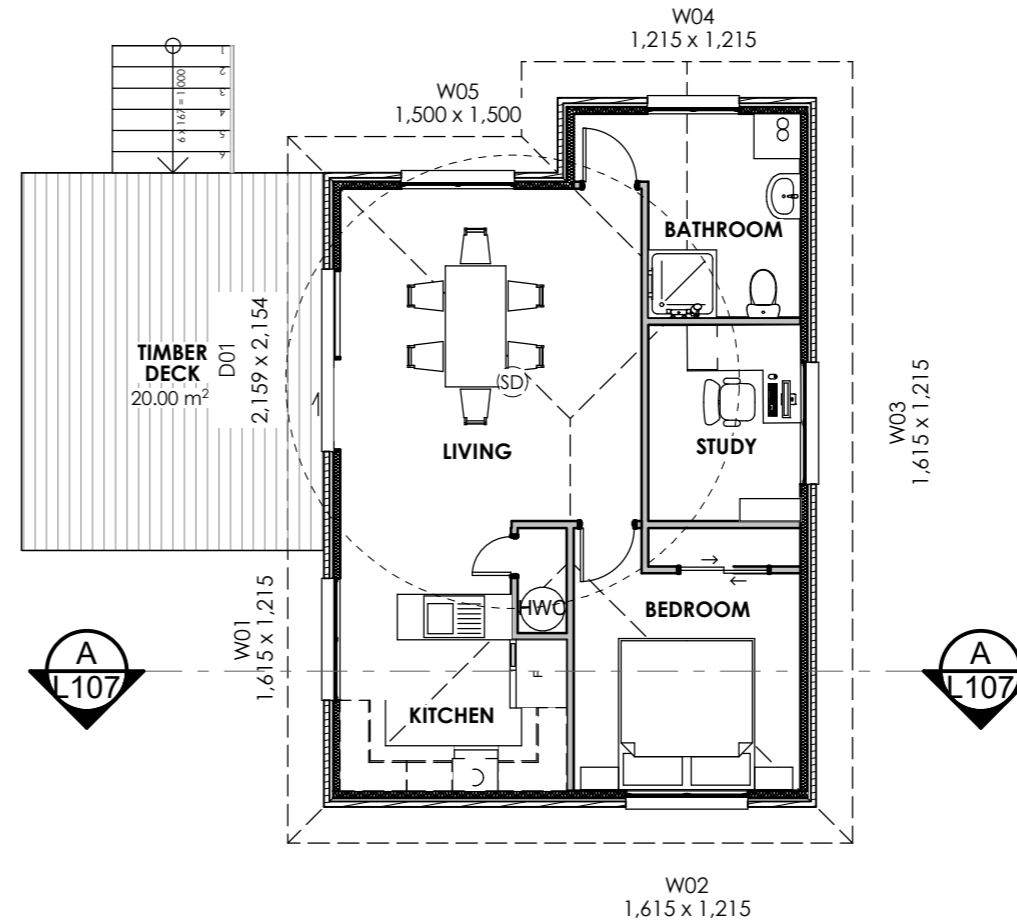
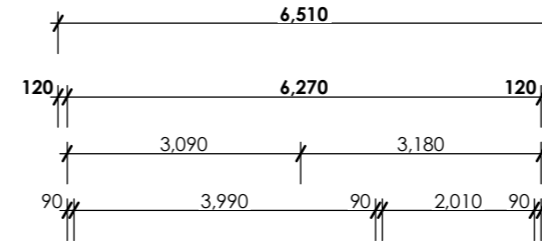
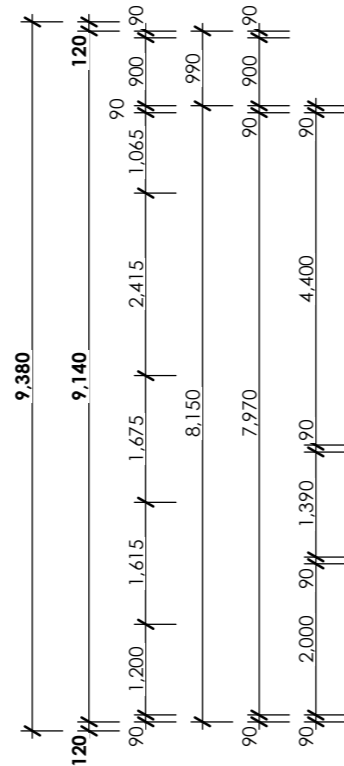

DWELLING FLOOR AREA	
FLOOR AREA OVER FRAME	=54.25m ²
FLOOR AREA OVER CLADDING	=58.0m ²
ROOF PLAN AREA	=74.18m ²

RevID	ChID	Revision	Date
BC-01		BUILDING CONSENT	4/07/2022



AgFox Architectural Solutions

AgFox Solutions

REV	SHEET	SHEET TITLE:	GROUND FLOOR PLAN
L101	REVISION #:	BC-01	
	DRAWN BY:	TJG	
	CHECKED BY:	B HANLEY	
	ISSUED:	4/07/2022	
	PROJECT #:	22-001	

Mr & Mrs Brian Cambell
CD 400 Assignment 3B
12 Sea Dune Place
Ruakaka,

PO BOX 1234
SCALE 1:100
PHONE: 021 2135 501
MOBILE: 022 345 6789
TimG@AgFoxDesign.co.nz
WWW.AgFoxDesign.CO.NZ